



VIVIANA
WESTIN-II

LIVE IN
WESTIN
FOREVER
BLISSIN

4 BHK PENTHOUSES



Iconic

a LANDMARK THAT
REDEFINES LUXURY

A masterpiece Standing tall,
Viviana Westin II symbolises grandeur and prestige,
where architectural brilliance meets timeless elegance.

 BHK
PENTHOUSES

UNPARALLELED

TWO MASTERPIECES -
ONE EXCLUSIVE ADDRESS

72

4 BHK DUPLEX
APARTMENTS

08

4 BHK TRIPLEX
APARTMENTS



**VIVIANA
WESTIN-II**

KHANPUR

THE
HEART OF
EXCLUSIVITY



-  MALLS / MULTIPLEX
-  SCHOOL / COLLEGE
-  RESTAURANT / HOTELS
-  HOSPITAL



GRANDEUR

A VISION OF
UNMATCHED EXCELLENCE

02 Towers

A STATEMENT OF
ARCHITECTURAL DISTINCTION

21 Storeys

ELEVATING LUXURY TO NEW HEIGHTS

04 Unit per floor

EXCLUSIVITY THAT ENSURES PRIVACY
& SPACE



REPRESENT EXCLUSIVITY &
ARCHITECTURAL EXCELLENCE



LAYOUT
GROUND FLOOR

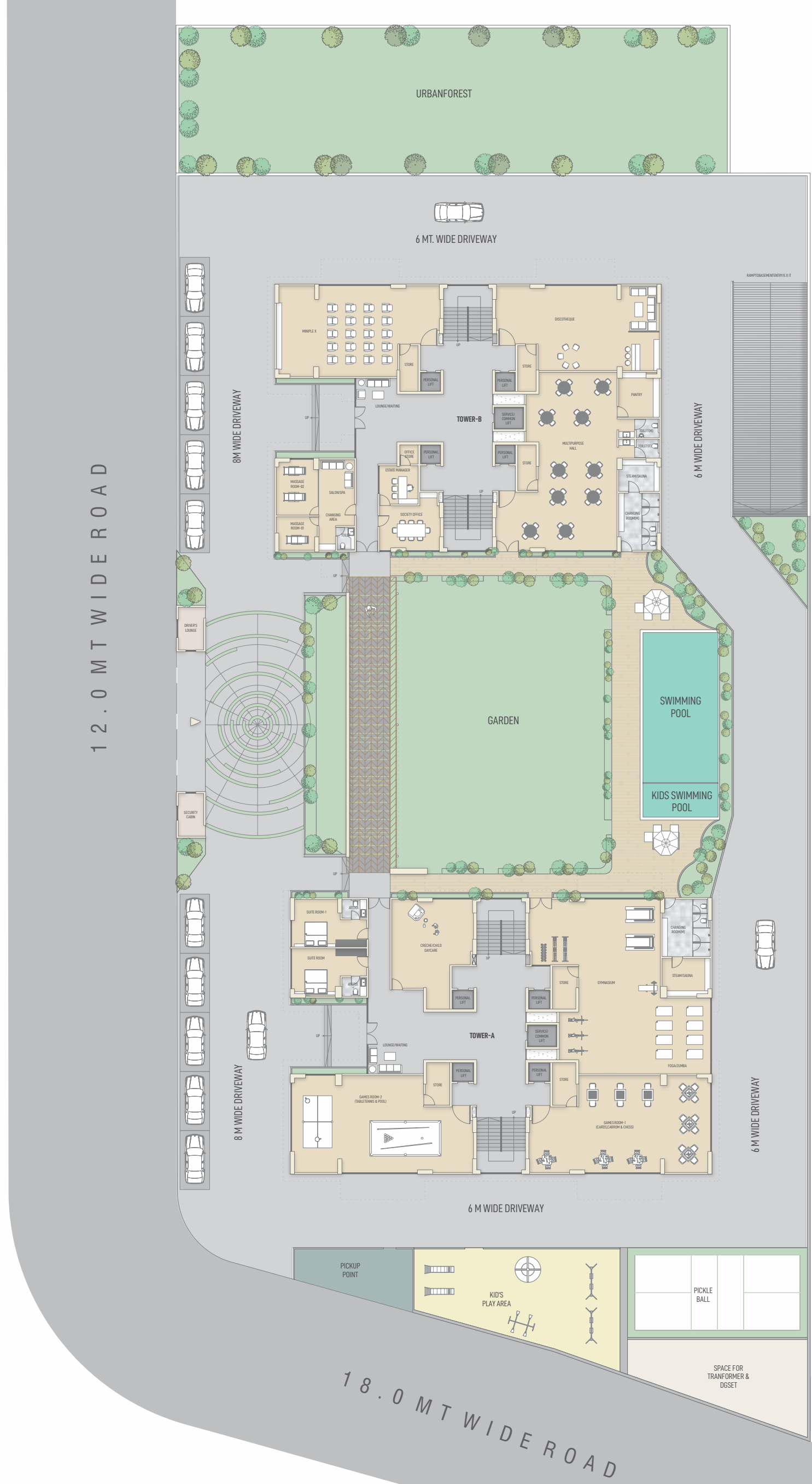

TYPICAL LAYOUT
4BHK UNIT
LOWER FLOOR LAYOUT

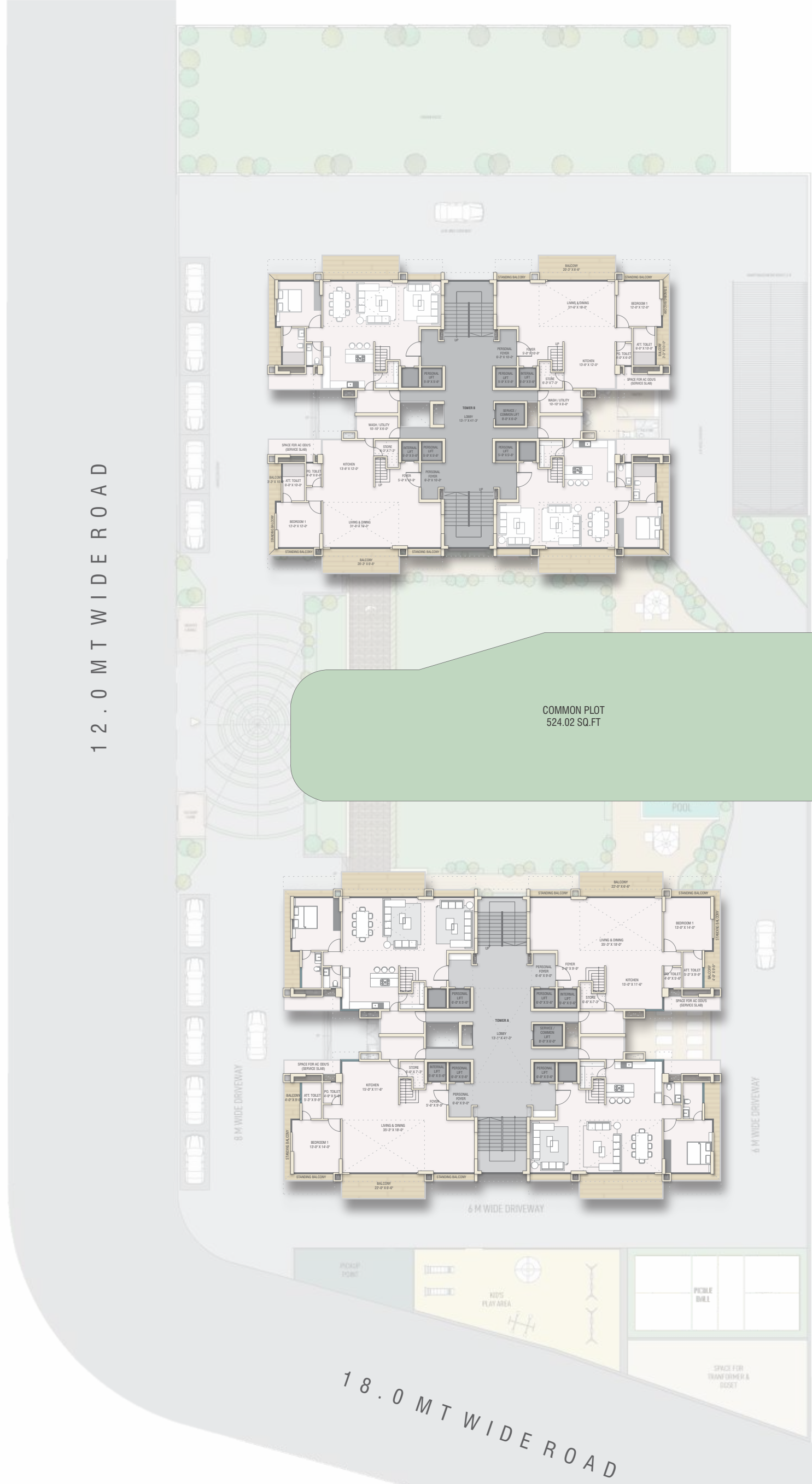

TYPICAL LAYOUT
4BHK UNIT
UPPER FLOOR LAYOUT



TYPICAL LAYOUT
4BHK UNIT
21st FLOOR LAYOUT



INDULGENCE

CURATED FOR THE ELITE

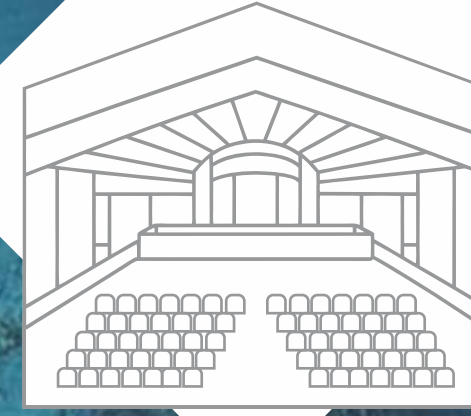
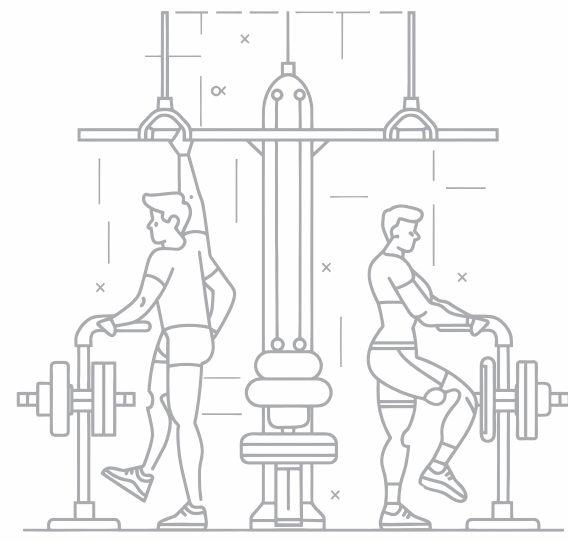

- GRAND ENTRY
- HUGE PLUSH GARDEN
- SWIMMING POOL WITH DEDICATED KIDS POOL
- FULLY EQUIPPED GYM
- INDOOR GAMES ROOM
- TABLE TENNIS AND POOL ROOM
- MOVIE THEATRE
- DISCOTHEQUE
- BANQUET HALL
- SPA AND SALOON ZONE
- HUGE LOUNGE AND WAITING AREA
- LAVISH GUEST SUITE ROOMS
- CHILD DAY CARE
- OPEN KIDS PLAY AREA
- PICKLE BALL COURT



VIVIANA
WESTIN-II

BASEMENT LAYOUT

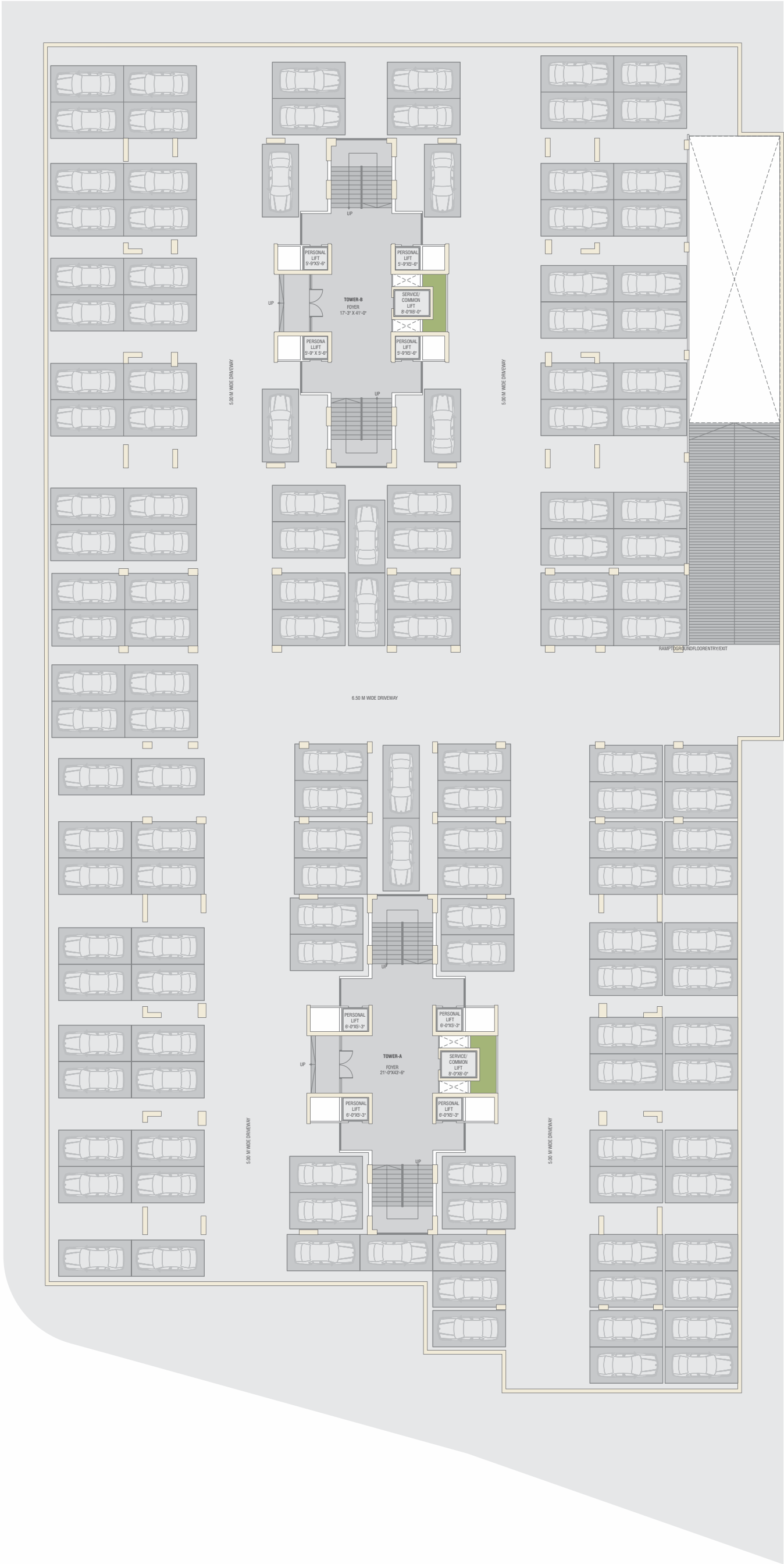

SPECIFICATION

STRUCTURE & WALL CONSTRUCTION

- Earthquake Resistant RCC Frame Structural Design.
- Internal Walls Finished with Putty & Primer
- External Walls Finished double coat plaster with standard semi Weather Proof Paint

ELECTRIFICATION

- Sufficient Electric Points with Concealed Premium Quality Wiring and Branded Modular Switches

FLOORING & WALL CLADDING

- Premium Vitrified Tiles Flooring with Skirting in all units
- Passage Area & Staircase with Premium Quality Vitrified Tiles / Granite

INFRASTRUCTURE

- RCC Trimix Finish road with Paver Block / Parking Tiles

DOORS & WINDOWS

- High Quality Decorative Main Door with Veneer Finish & Internal Doors Flush Door with both side Laminate
- Aluminum Powder Coated Sliding openable Windows

WATER SUPPLY

- 24 hour Ground Water supply through Overhead & Underground Storage Tanks From Borewell
- CPVC Plumbing Lines
-

Developers :

ADDRESS :

Viviana Westin 2,
Khanpur, Vadodara – 391101

+91 **7600085001/ 03**

info@westin.in

www.westingroup.in

ARCHITECT:



STRUCTURE:



**GEO DESIGNS &
RESEARCH PVT. LTD.**